

# PY-C

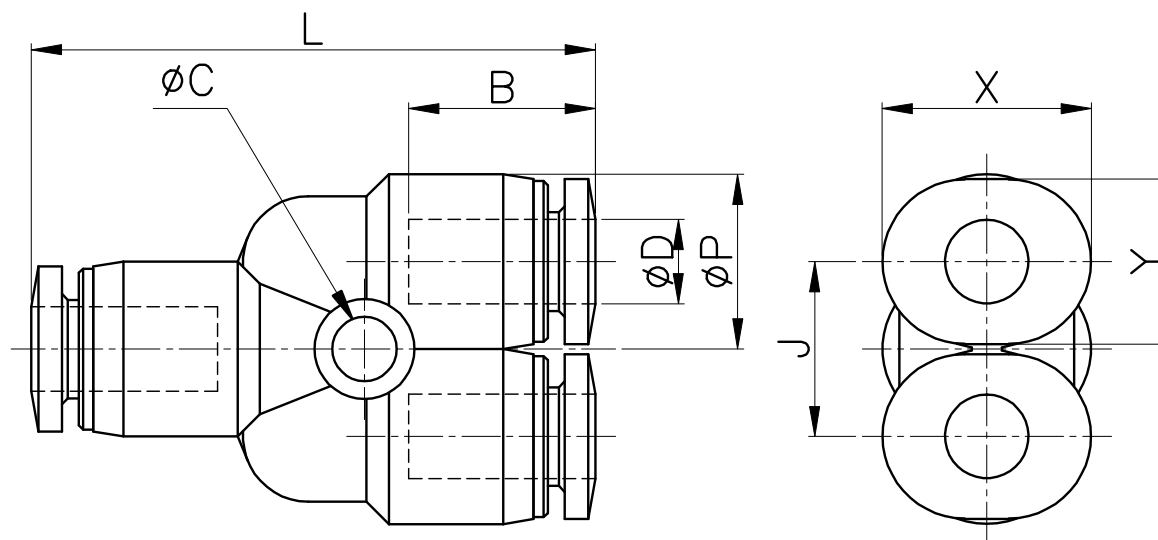

MODEL	$\phi D$	$\phi P$	L	J	$\phi C$	B	X	Y	ORIFICE	WEIGHT (g)	BOX(EA)
PY 03C	3	7.6	26.8	7.6	3.2	11.3	9.2	7.2	2.4	3.0	100
PY 04C	4	8.7	28.0	8.7		11.8	10.4	8.2	3.0	5.0	100
PY 06C	6	10.8	30.6	10.8		12.8	12.4	10.2	4.0	6.0	100