

# PT

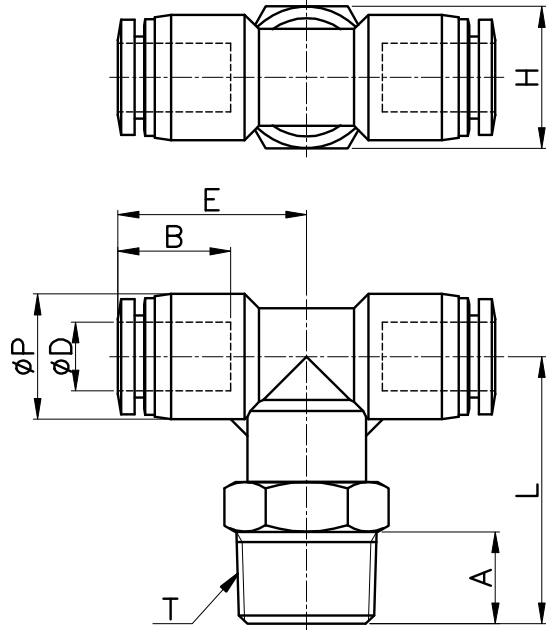

MODEL	ØD	ØP	T	L	E	A	B	H (Hex)	ORIFICE	WEIGHT (g)	BOX(EA)
PT 04-M5	4	10.5	M5*0.8p	20.5	18.5	4.0	14.8	10	3.0	10.0	100
PT 04-M6			M6*1.0p	20.6		4.1		10.0		100	
PT 04-01			R 1/8	24.5		8.0		10		11.0	100
PT 04-02			R 1/4	26.5		10.0		14		17.0	100
PT 04-03			R 3/8	27.5		11.0		17		26.0	50
PT 06-M5	6	12.5	M5*0.8p	22.5	20.3	4.0	16.4	12	4.0	15.0	50
PT 06-M6			M6*1.0p	22.6		4.1		12		15.0	50
PT 06-01			R 1/8	26.5		8.0		12		17.0	50
PT 06-02			R 1/4	29.5		10.0		14		21.0	50
PT 06-03			R 3/8	30.5		11.0		17		29.0	50
PT 06-04			R 1/2	33.5		14.0		21		56.0	25
PT 08-01	8	15.0	R 1/8	28.0	22.6	8.0	18.3	14	6.0	21.0	50
PT 08-02			R 1/4	31.0		10.0		14		24.0	50
PT 08-03			R 3/8	32.0		11.0		17		31.0	50
PT 08-04			R 1/2	35.0		14.0		21		54.0	25
PT 10-01	10	17.5	R 1/8	28.5	25.2	8.0	20.2	17	8.0	33.0	25
PT 10-02			R 1/4	31.5		10.0		17		35.0	25
PT 10-03			R 3/8	32.5		11.0		17		36.0	25
PT 10-04			R 1/2	35.5		14.0		21		60.0	25
PT 12-01	12	20.5	R 1/8	32.4	28.7	8.0	22.9	19	6.0	50.0	25
PT 12-02			R 1/4	34.4		10.0		19		47.0	25
PT 12-03			R 3/8	35.4		11.0		19	50.0	25	
PT 12-04			R 1/2	38.4		14.0		21	60.0	20	
PT 16-03	16	25.5	R 3/8	42.8	32.8	11.0	24.1	24	10.0	86.0	12
PT 16-04			R 1/2	45.8		14.0		24	13.0	94.0	12