

PHT(2)

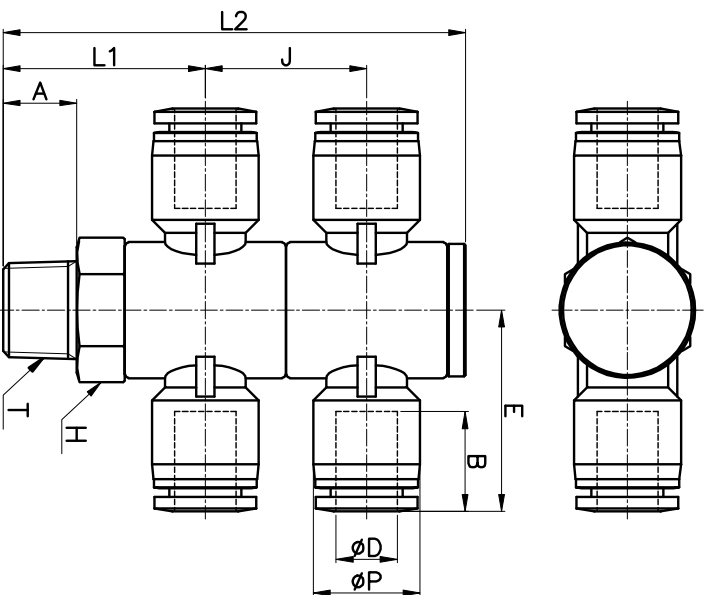

MODEL	∅D	∅P	T	L1	L2	E	A	B	J	H (Hex)	ORIFICE	WEIGHT	
												(g)	BOX(EA)
PHT 04-01(2)	4	10.5	R 1/8	22.5	51.8	23.3	8.0	14.8	17.9	14	3.2	43.0	25
PHT 04-02(2)			R 1/4	27.5	62.8	25.1	10.0					66.0	25
PHT 04-03(2)			R 3/8	29.0	64.8	27.0	11.0					93.2	12
PHT 04-04(2)	6	12.5	R 1/2	34.1	73.4	29.0	14.0	16.4	23.9	24	4.0	131.2	12
PHT 06-01(2)			R 1/8	22.5	51.8	24.1	8.0					41.8	25
PHT 06-02(2)			R 1/4	27.5	62.8	26.0	10.0					69.0	20
PHT 06-03(2)			R 3/8	29.0	64.8	27.9	11.0					94.8	16
PHT 06-04(2)			R 1/2	34.1	73.4	29.3	14.0					135.8	12
PHT 08-01(2)			R 1/8	22.5	51.8	25.6	8.0					50.0	20
PHT 08-02(2)	8	14.5	R 1/4	27.5	62.8	27.4	10.0	18.3	17.9	14	5.0	73.0	20
PHT 08-03(2)			R 3/8	29.0	64.8	29.3	11.0					96.8	12
PHT 08-04(2)			R 1/2	34.1	73.4	30.7	14.0					138.8	12
PHT 10-01(2)	10	17.5	R 1/8	22.5	51.8	28.1	8.0	20.2	23.9	24	5.0	60.0	15
PHT 10-02(2)			R 1/4	27.5	62.8	29.8	10.0					69.8	12
PHT 10-03(2)			R 3/8	29.0	64.8	31.9	11.0					118.0	9
PHT 10-04(2)			R 1/2	34.1	73.4	33.7	14.0					144.8	9
PHT 12-02(2)			R 1/4	27.5	62.8	33.0	10.0					99.0	9
PHT 12-03(2)			R 3/8	29.0	64.8	35.1	11.0					130.0	9
PHT 12-04(2)	R 1/2	34.1	73.4	37.4	14.0	174.0	8						