

HVM

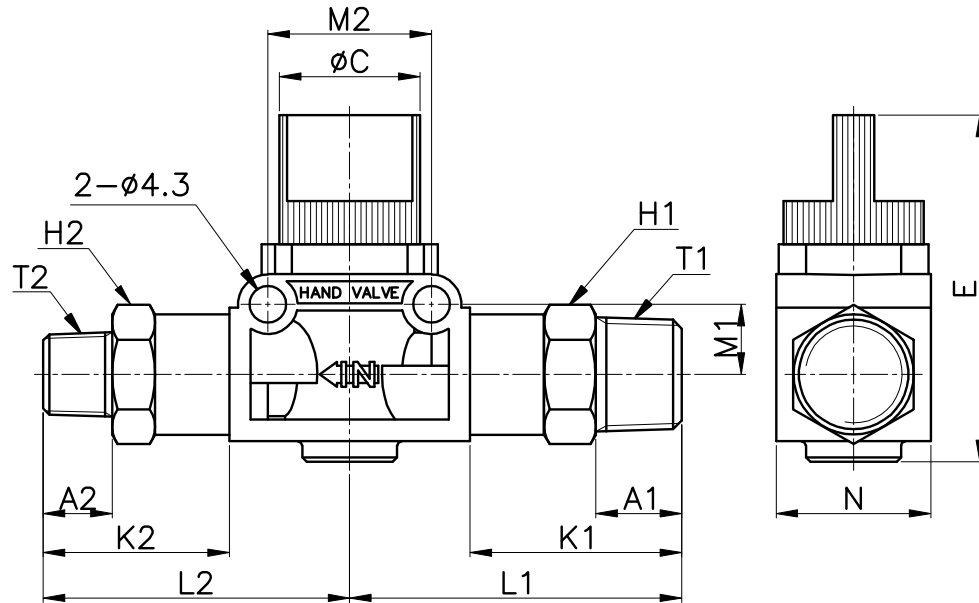

MODEL	T1	T2	H1 (Hex)	H2 (Hex)	ϕC	N	E	A1	A2	K1	K2	L1	L2	M1	M2	WEIGHT (g)	BOX(EA)
HVM 01-01	R 1/8	R 1/8	14	14	16.3	18.0	40.3	8.0	8.0	21.6	21.6	35.6	35.6	8.2	19.0	47.0	25
HVM 02-01	R 1/4	R 1/8	14	14	16.3	18.0	40.3	10.0	8.0	24.6	21.6	38.6	35.6	8.2	19.0	49.0	25
HVM 02-02		R 1/4		14					10.0		24.6		24.6			38.6	50.0
HVM 03-02	R 3/8	R 1/4	17	17	19.3	21.2	40.5	11.0	10.0	24.0	24.6	40.5	38.6	10.9	24.0	64.0	20
HVM 03-03		R 3/8		17					11.0		24.0		40.5			83.0	20
HVM 04-03	R 1/2	R 3/8	21	19	19.3	21.2	40.5	14.0	11.0	28.6	24.0	45.1	40.5	10.9	24.0	103.0	15
HVM 04-04		R 1/2		21					14.0		28.6		45.1			121.0	15